

FIREBOX®SOHO 6 WIRELESS QUICKSTART GUIDE

www.watchguard.com

Thank you for choosing the Firebox® SOHO 6 Wireless security appliance to protect your data and computers. This QuickStart Guide gives you an overview of how to install and configure the SOHO 6 Wireless so that computers connected directly to the SOHO 6 Wireless and computers connected through a wireless connection are protected from security hazards. Please read the *WatchGuard® Firebox® SOHO 6 Wireless User Guide* for detailed installation and configuration information.

FIREBOX® SOHO 6 PACKAGE CONTENTS:

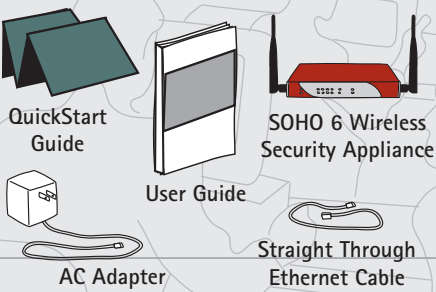

The SOHO 6 Wireless protects computers that are connected to it by Ethernet cable or wireless connection. Because WatchGuard is concerned about the security of your network, the wireless feature is turned off on the SOHO 6 Wireless we ship you. This allows you to enable the wireless network after you set up the desired security.

The steps involved to set up the wireless network are:

- Install the SOHO 6 Wireless
- Set up the Wireless Network
- Set up the Wireless Access Point
- Configure the Wireless Card on your computer

To complete the setup, you need:

- DSL/cable modem
- SOHO 6 Wireless with Ethernet cables and power supply
- Computer connected by Ethernet Cable to the SOHO 6 Wireless
- Computer with wireless card (for wireless)

INSTALLING THE SOHO 6 WIRELESS

Determine how your Internet Service Provider (ISP) issues your IP address. This will affect the installation process. Call your ISP to find out whether your Internet connection supports static addressing, DHCP, or PPPoE. Before you begin, confirm that you have a working Internet connection. Then follow the steps below to install your SOHO 6 Wireless:

TCP/IP SETTINGS:
for static addressing

IP Address _____

Subnet Mask _____

Default Gateway _____

Primary DNS _____

Secondary DNS _____

DNS Domain Suffix _____

PPPoE SETTINGS:

Name _____

Domain _____

Password _____

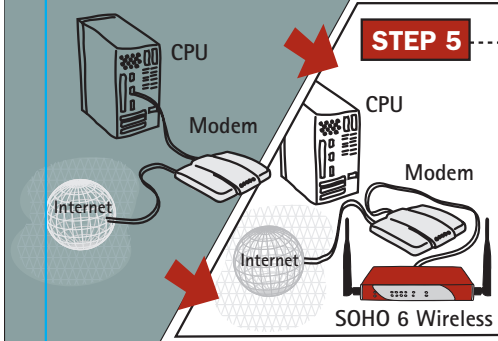

STEP 5

1 Look up the computer's TCP/IP settings and record them for later use. Refer to "Determine your current TCP/IP settings" in the *WatchGuard® Firebox® SOHO 6 Wireless User Guide*.

2 Set up your computer to use DHCP. Refer to "Enable your Computer for DHCP" in the *WatchGuard® Firebox® SOHO 6 Wireless User Guide*.

3 Confirm that your Web browser's HTTP proxy is disabled. Refer to "Disable the HTTP proxy setting" in the *WatchGuard® Firebox® SOHO 6 Wireless User Guide*.

4 Shut down your computer. If you connect to the Internet using a DSL/cable modem, disconnect the power from this device.

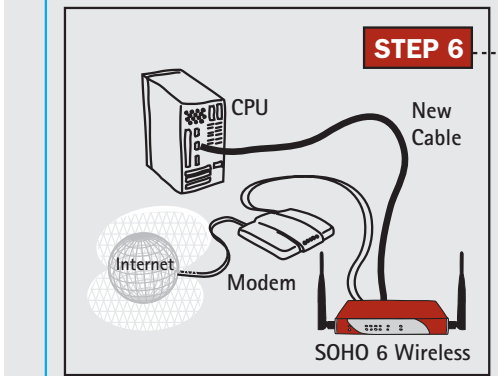

STEP 6

5 Disconnect the Ethernet cable that runs from your DSL/cable modem or other Internet connection to your computer and connect it to the WAN port on the SOHO 6 Wireless.

6 Connect one end of the straight-through Ethernet cable supplied with your SOHO 6 Wireless into any of the four, numbered Ethernet ports (labeled 0-3). Connect the other end into the Ethernet port of your computer.

7 If you connect to the Internet using a DSL/cable modem, restore the power to this device. When the indicator lights of the modem stop flashing, the modem is ready for use.

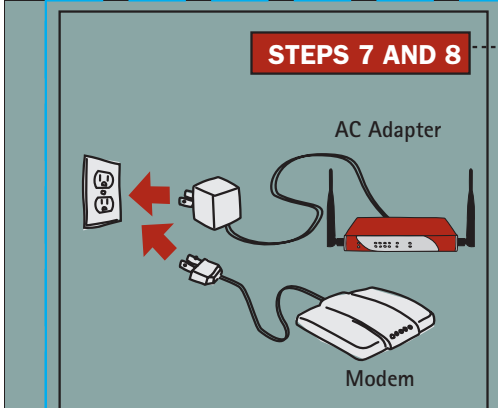

STEPS 7 AND 8

8 Attach the AC adapter to the SOHO 6 and connect it to a power source.

9 If you use DHCP, skip this step. If your ISP supplies static IP addressing, or uses PPPoE, then do the following.

- A. With your Web browser, go to the System Status page using the Trusted IP address of the SOHO 6 Wireless, <http://192.168.111.1>. From the navigation bar on the left side, click **Network => External**.
- B. Select either **Manual Configuration** (for static IP addressing) or **PPPoE Client** from the Configuration Mode drop list.
- C. Enter the TCP/IP settings or the PPPoE information you recorded in Step 1 above.

10 Register your SOHO 6 Wireless and activate your bundled LiveSecurity Service subscription. With your Web browser, go to: <http://www.watchguard.com/activate>.

REGISTER NOW!
WatchGuard
LiveSecurity® Service

STEP 10

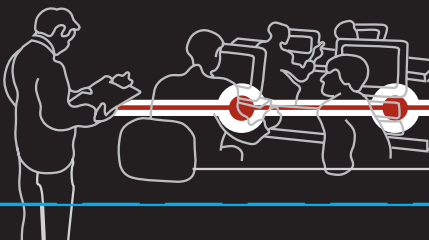

CONGRATULATIONS

Your SOHO 6 Wireless is now protecting the computers that are connected to it from security hazards. To expand this coverage to include your wireless appliances, please refer to the opposite side of this QuickStart Guide to set up the wireless connection.



Now that you have installed the SOHO 6 Wireless device, you can set up the optional wireless network. You need to set up the optional network, wireless connection and wireless card to complete the wireless set up.

NOTE: For the initial wireless connection, please place the computer within 10 feet of the SOHO 6 Wireless device, and make sure your wireless card is enabled.

Setting Up the Wireless Network

Follow the steps below to set up the optional network and turn on the wireless network:

- 1** Type the IP address of the trusted network in the browser window of the computer connected to the SOHO 6 Wireless to connect to the System Status page of the SOHO 6 Wireless. The default IP address is: <http://192.168.111.1>
- 2** From the navigation bar on the left side, select **Network =>Optional (802.11b)**. The Optional Network Configuration page appears.
- 3** Select the **Enable Optional Network** checkbox to turn on the wireless network.
- 4** Type the IP Address and Subnet Mask of the wireless network. The default IP Address is 192.168.112.1. The default Subnet Mask is 255.255.255.0.
- 5** Select **Enable DHCP Server on the Optional Network** checkbox.
- 6** Type the First address for DHCP server. The default is 192.168.112.2. Click **Submit**.

You are done with the basic setup of the optional network. For more information on configuring the optional network, refer to the *WatchGuard® Firebox® SOHO 6 Wireless User Guide*.

Setting Up the Wireless Access Point

Follow the steps below to set up the wireless connection:

- 1** From the navigation bar on the left side, select **Network =>Wireless Configuration**. The Wireless Network Configuration page appears.
- 2** From the **Encryption** drop-down list, select **Disabled**.
- 3** From the **Authentication** drop-down list, select **Open System**.
- 4** In the **Basic Settings**, write down the number in the SSID text box for later use. The SSID is the wireless devices identification number, and it is used to create the wireless connection. The default SSID is the 5 digit serial number for your SOHO 6 Wireless device.
- 5** Click **Submit**.

Configuring the Wireless Card on Your Computer

NOTE: The following instructions are for the Windows XP operating system. Refer to the WatchGuard SOHO 6 Wireless User Guide for instructions on other operating systems.

- 1** Click **Start => Control Panel => Network Connections**. The Network Connections dialog box appears.
- 2** Double-click on the Wireless Network Connection. The Wireless Network Connection dialog box appears.
- 3** Click **Advanced**. The Wireless Network Connection Properties dialog box appears with the Wireless Networks tab selected.
- 4** In the Preferred networks section, click **Add**. The Wireless network properties dialog box appears.
- 5** Type the SSID that you wrote down from the Wireless Network Configuration page into the Network name (SSID) text box.
- 6** Click **OK** to close the Wireless Network Properties dialog box.
- 7** Click **Refresh**. Windows looks for all wireless access points and lists them in the Available Networks text box. Select the SSID of the SOHO 6 Wireless.
- 8** Click **OK** to close the Wireless Network Connection Properties dialogue box and enable the wireless connection.
- 9** Set up your wireless network to use DHCP. Refer to "Enable your Computer for DHCP" in the *WatchGuard® Firebox® SOHO 6 Wireless User Guide*.

CONGRATULATIONS

Your Firebox SOHO 6 Wireless is now shielding your wired and wireless computers from network security hazards. To make your security settings even stronger, see the *WatchGuard® Firebox® SOHO 6 Wireless Guide*.

Contacting WatchGuard Technical Support

1-877-232-3531
U.S. End-User Support

1-206-521-8375
U.S. Authorized Reseller Support

+1-360-482-1083
International Support

For more information on wireless networks, refer to the WatchGuard website FAQ:
www.watchguard.com/support

Why Activate?

Defense against today's evolving exploits requires vigilance. LiveSecurity Service extends your protection with software updates, emerging threat alerts, expert security articles, and one year of McAfee® VirusScan® ASaP, compliments of WatchGuard. What's more, your subscription gives you access to our comprehensive help resources, online knowledge base and flexible technical support options. Stay ahead of the threats by activating today.

For more instructions on activating your LiveSecurity Service, refer to "Register SOHO 6 and Activate the LiveSecurity Service" in the *WatchGuard® Firebox® SOHO 6 Wireless User Guide*.

To test that your Internet connection is working properly, use your web browser to go to www.watchguard.com. If the WatchGuard Home Page does not appear, see the Troubleshooting tips section in the *WatchGuard® Firebox® SOHO 6 Wireless User Guide*.