



WatchGuard® SSL 500  
WatchGuard® SSL 1000

# Setup Guide



## WatchGuard SSL 500 and SSL 1000 Setup

---

### 1 Register your WatchGuard SSL User Pack with LiveSecurity® Service

- Find the license that came with your WatchGuard SSL User Pack.
- Go to <http://www.watchguard.com/activate>.
- Log in.



*If you are new to WatchGuard, follow the instructions to create a profile.*

- Follow the instructions on the screen.
- Record your selected domain name for later use.
- Download and extract the **License\_WGLic.tgz** file. You will need this file in step 4.

---

### 2 Download WatchGuard software

- Go to <https://www.watchguard.com/archive/softwarecenter.asp>.
- Download the most current versions of the WatchGuard SSL software installers.
  - ◆ **Administration Service**
  - ◆ **Authentication Service**
  - ◆ **Policy Service**
  - ◆ **Access Point Update (SSL\_2.x.zip, if available)**
- Open the **SSL\_2.x.zip** file and extract the update file to a location where you can access it later.

### 3 Install the WatchGuard Administrator software

#### System Requirements

Hardware	Operating System	Browser
Single Intel Pentium III, Pentium 4, or Xeon 1 GHz processor or higher	Microsoft Windows 2003 Server	Microsoft Internet Explorer 7.0
2 GB of RAM (3x512 plus 512)	Microsoft Windows XP	Microsoft Internet Explorer 6.0
Hard disk drive with at least 300 MB of free space		Mozilla Firefox 2.0

- Select a dedicated computer on which to install the WatchGuard Administrator services. If you turn this computer off, the services do not run and no connections to the WatchGuard SSL device can be made.
- Run the WatchGuard Administrator installation program, **AdministrationService.exe**.



*If you have a desktop firewall or Windows firewall, you must disable it before you install WatchGuard Administrator.*

- To start your service, reboot your system or use the Windows **Control Panel > Administrative Tools > Services** applet to manually start the **WatchGuard Admin Service**.

### 4 Set up your system

- Go to <https://127.0.0.1:8443>.
- When **WatchGuard Administrator** launches, click **Log on** to start the Setup System wizard.
- Click **Browse** to add your license file.
- Follow the steps in the wizard to complete the installation.



*WatchGuard Administrator assigns a Service ID to each service as it is added. Record the Service ID number for use when you install the services.*

- Remember your Super Administrator user name and password for later use.

---

## 5 Install WatchGuard Authentication Service

- Run **AuthenticationService.exe**.
- Follow the steps in the wizard to complete the installation.



*The default Service ID number is 4.*

- When prompted for the system IP address, type the IP address of the computer on which you are installing this service.
- Reboot your computer or use the Windows **Control Panel > Administrative Tools > Services** applet to manually start the **WatchGuard Authentication Service**.

---

## 6 Install WatchGuard Policy Service

- Run **PolicyService.exe**.
- Follow the steps in the wizard to complete the installation.



*The default Service ID number is 3.*

- When prompted for the system IP address, type the IP address of the computer on which you are installing this service.
- Reboot your computer or use the Windows **Control Panel > Administrative Tools > Services** applet to manually start the **WatchGuard Policy Service**.

---

## 7 Verify your services are installed in WatchGuard Administrator

- From WatchGuard Administrator, go to **Monitor System > System Status**. An error message appears for any system component that is not running.



*At this point in the setup process, you see an error that the Access Point is not running. The Authentication Service and Policy Service should be running. If either of these services is not running, restart the service.*

- Reboot your computer.

## 8 Configure your WatchGuard SSL Access Point

- Connect Eth1 on your WatchGuard SSL Access Point device to the ethernet interface of a computer configured with an IP address on the 192.168.111.0/24 network. The default IP address of Eth1 on the WatchGuard SSL device is 192.168.111.1.
- Go to <http://192.168.111.1:8080>. When prompted, log on with default log in credentials:

<b>User Name:</b> admin	<b>Password:</b> admin
-------------------------	------------------------

- To update your Access Point software, select **Administration > Update** and browse to the location where you saved the new Access Point software in step 2.
- Before you configure your Access Point you must decide how the Access Point best fits your network needs. Use the method that matches the architecture you select.

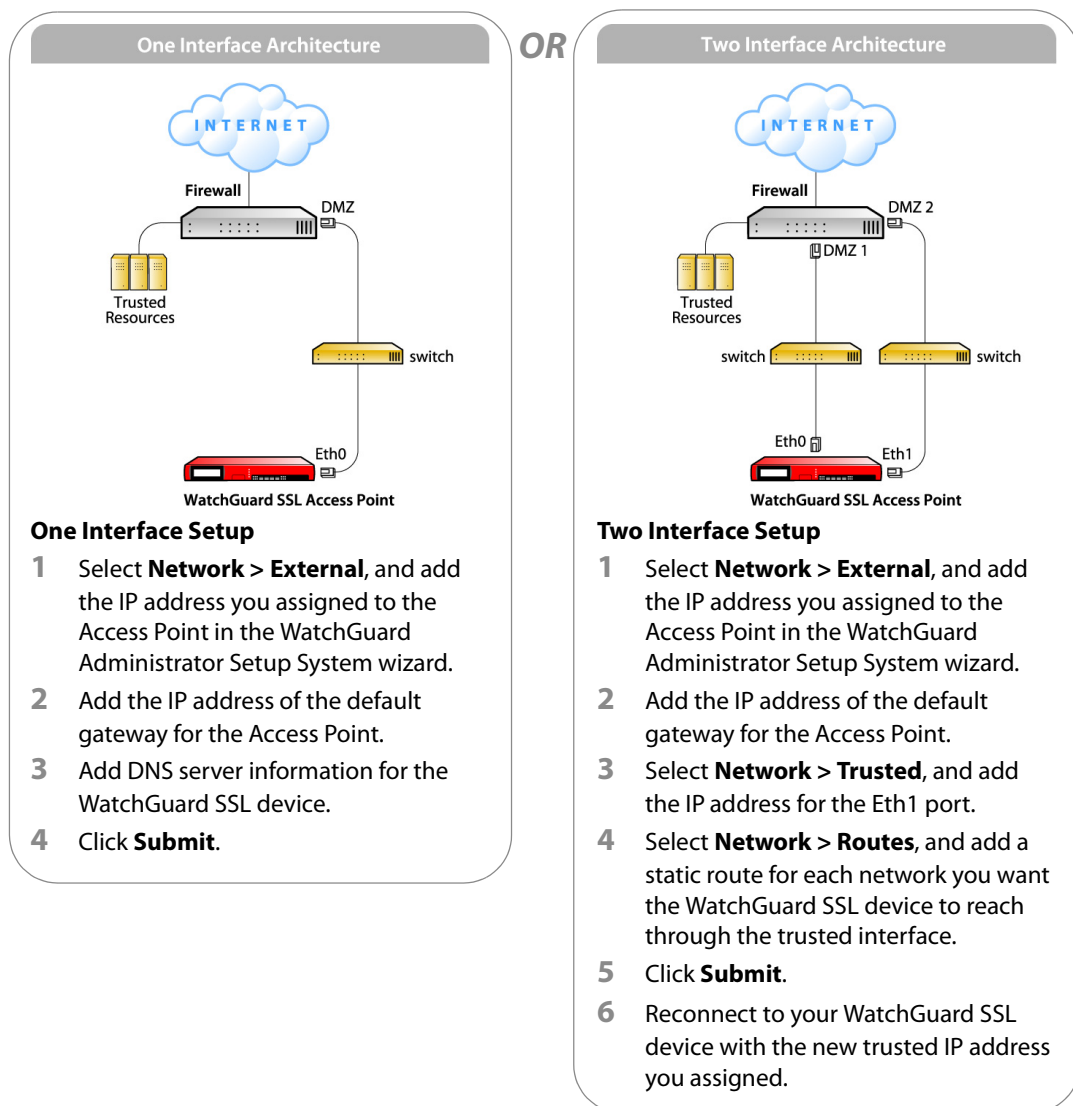

- Select **Network > Admin Service**, and add the IP address of your Administration Service computer.
- Select **Administration > System Time**, and set the time zone and date for your WatchGuard SSL device.

---

## Next Steps

- Add your WatchGuard SSL device to your network.



*If you did not configure a directory service when you ran the Setup System wizard, make sure you add one now. You cannot add users until you select a directory service.*

- Add user accounts to your network.
- Add resources to your network.
- Advise your users to connect to the WatchGuard SSL authentication portal with a URL that includes the domain name you recorded in step 1.

For more information about installation procedures and using WatchGuard Administrator, see the *WatchGuard Administrator User Guide*, available on the web at <http://www.watchguard.com/help/documentation>.

## WatchGuard SSL LiveSecurity® Service

LiveSecurity® Service from WatchGuard is the most comprehensive support and maintenance offering in the industry, putting a global team of security experts behind you to make the complex job of IT management easier. LiveSecurity Service provides:

- Hardware warranty with advance hardware replacement
- Software updates
- Rapid-response technical support
- Up-to-the-minute security alerts
- Innovative education resources, including videos, podcasts, and handy security-training modules for end users

An initial 90-day LiveSecurity subscription is automatically activated for a new WatchGuard SSL 500 or SSL 1000 installation when you activate your user pack.



### ADDRESS

505 Fifth Avenue South  
Suite 500  
Seattle, WA 98104

### SUPPORT

[www.watchguard.com/support](http://www.watchguard.com/support)  
U.S. and Canada +877.232.3531  
All Other Countries  
+1.206.613.0456

### SALES

U.S. and Canada +1.800.734.9905  
All Other Countries  
+1.206.613.0895

No express or implied warranties are provided for herein. All specifications are subject to change and any expected future products, features or functionality will be provided on an if and when available basis. ©2008 WatchGuard Technologies, Inc. All rights reserved. WatchGuard, the WatchGuard Logo, Firebox, and Livesecurity are either trademarks or registered trademarks of WatchGuard Technologies, Inc. in the United States and/or other countries. All other trademarks and tradenames are the property of their respective owners. Part No. 352-2947-001

---